

INSTALLATION MANUAL FOR AUTOMATICALLY OPERATED MSF102 TYPE SLIDING DOOR

1. PURPOSE

This manual covers the installation instructions for automatically operated MSF102 type sliding doors.

2. FRAME INSTALLATION

MSF102 sliding door set is either with or without installation supporting frame.

If the door is ordered with installation supporting frame, smoke lists and bottom guide will be fixed to the frame.

2.1 Installation of the supporting frame

- 1) Connect the parts 1 and 2 of the frame together using M6x60mm stainless steel bolts.

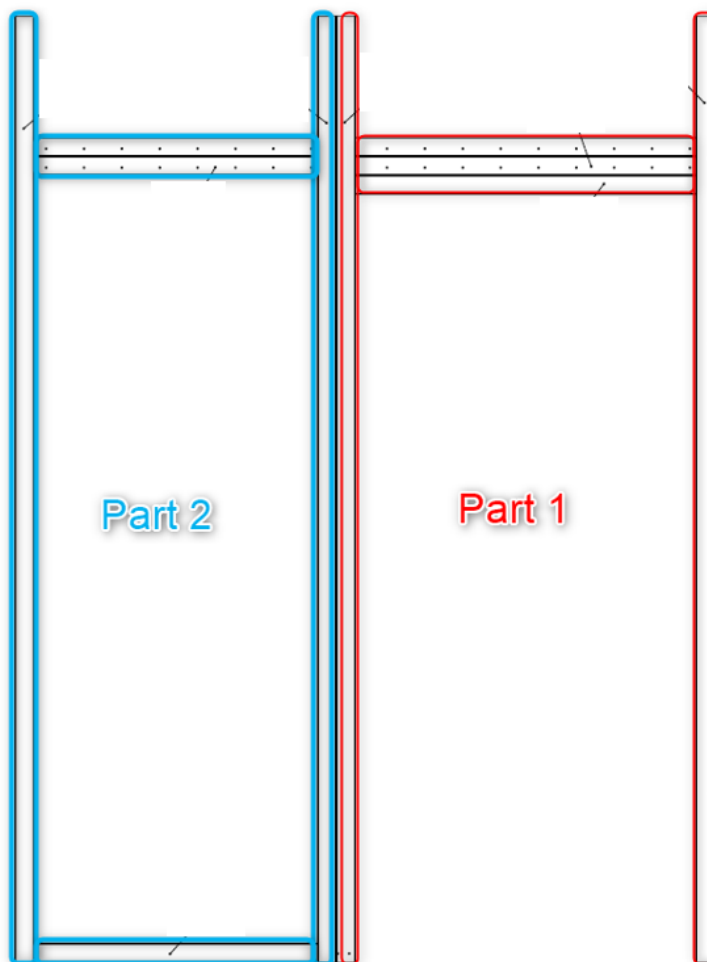

Drawing 1

- 2) Place the supporting frame in place and weld it to the wall.

STEEL PROFILE DOORS / METAL DOORS / MARINE DOORS

3. DORMA ES200 DRIVE UNIT INSTALLATION

- 1) Position the drive unit in line with the edge of the installation supporting frame back edge or 50mm from the wall opening edge as shown on drawing 2.

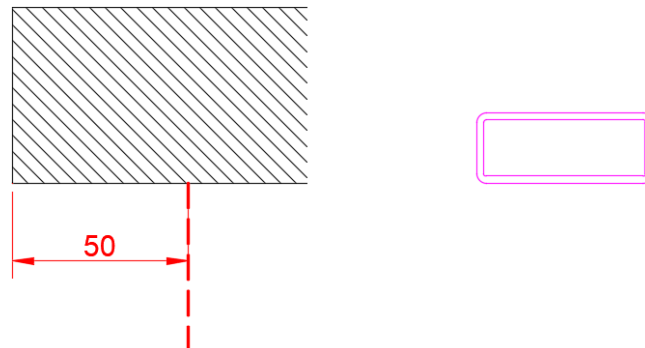

Drawing 2

The drive unit upper edge should be 200mm above the wall opening.

Drive unit height= $H(HIB) + 200\text{mm}$ measured from the finished floor/sill to upper edge of the drive system rail.

- 2) Fix the rail with self-drilling screws 4,8x19mm to the wall structure or installation supporting frame as shown on drawing 3.

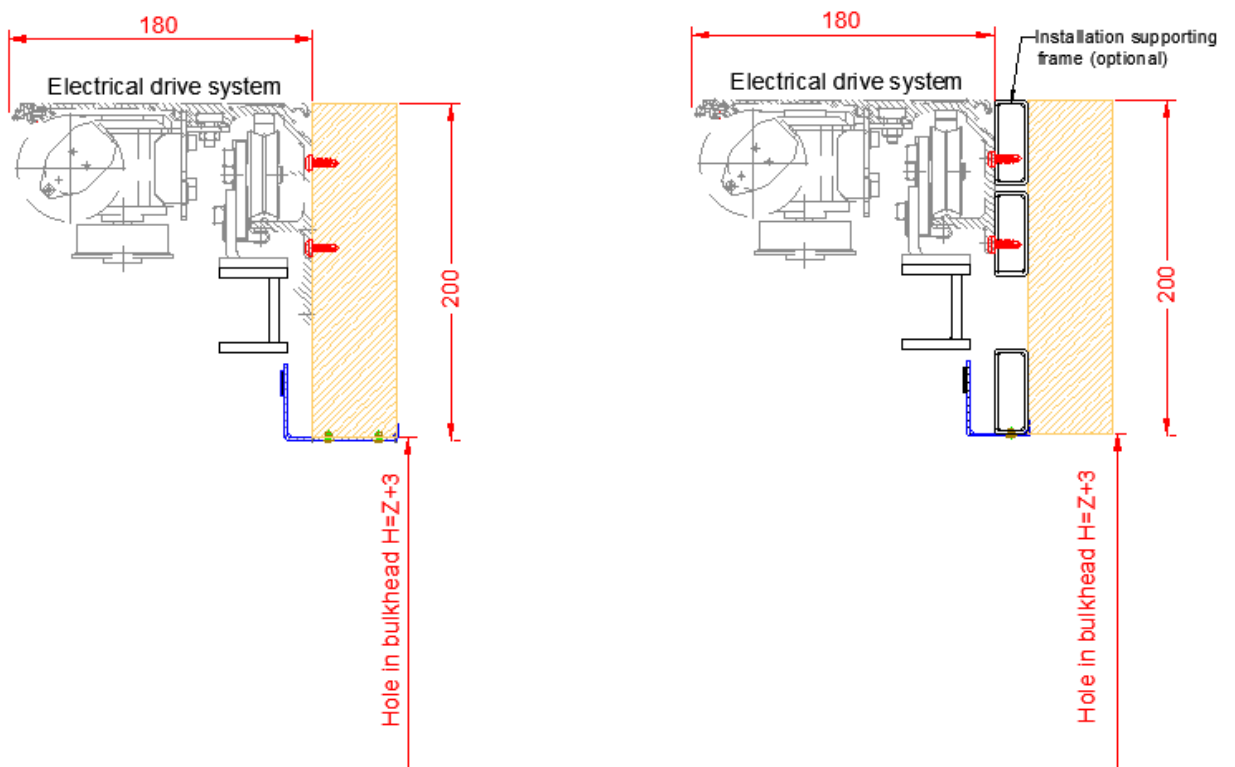

Drawing 3

4. DOOR LEAF INSTALLATION

- 1) Place the door leaf on the bottom guide. Bottom guide is already fixed to the installation supporting frame. If the bottom guide came separately, fix it to the wall/bulkhead using self-drilling screws or welding. Positioning on the bottom guide is shown on drawing 4.

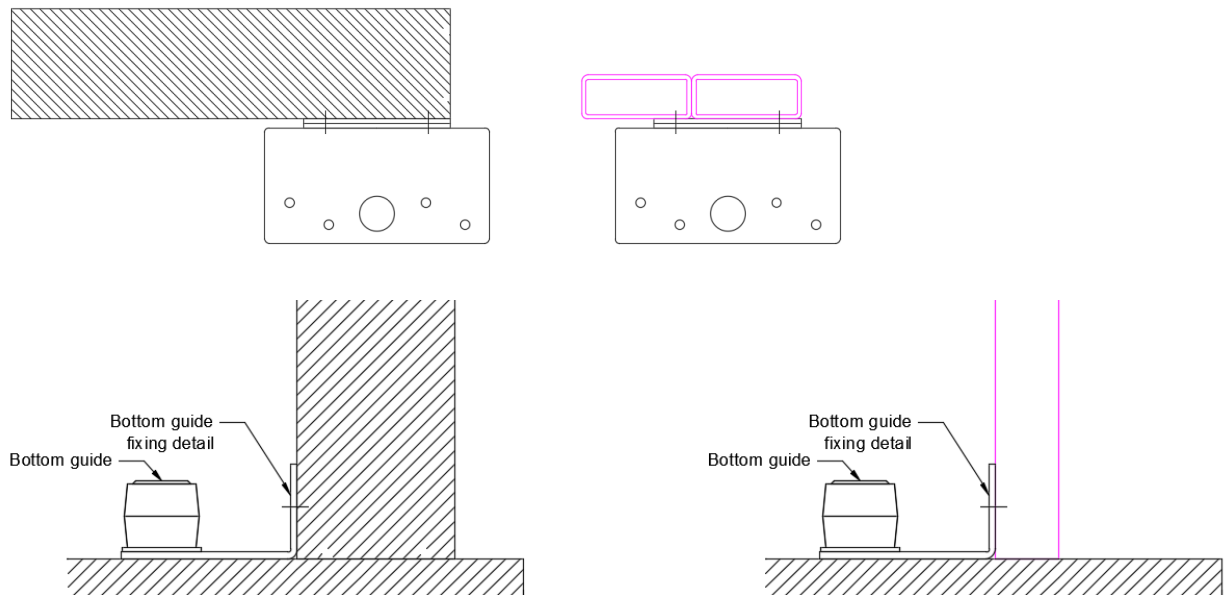

Drawing 4

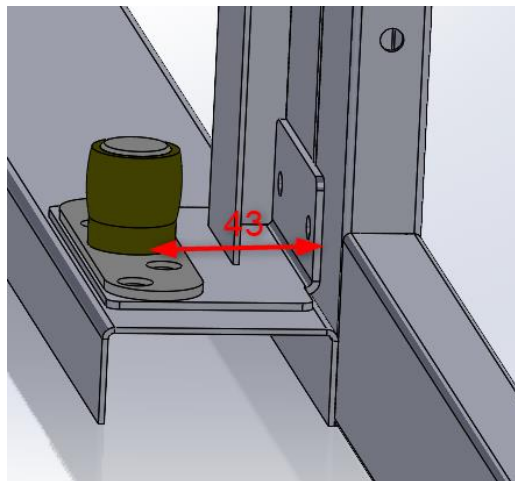

- 2) Install door leaf with 4pcs of M8 fixing bolts through 2 carriage hang wheels.
NB! Leave the bolts loose for door leaf adjustment!

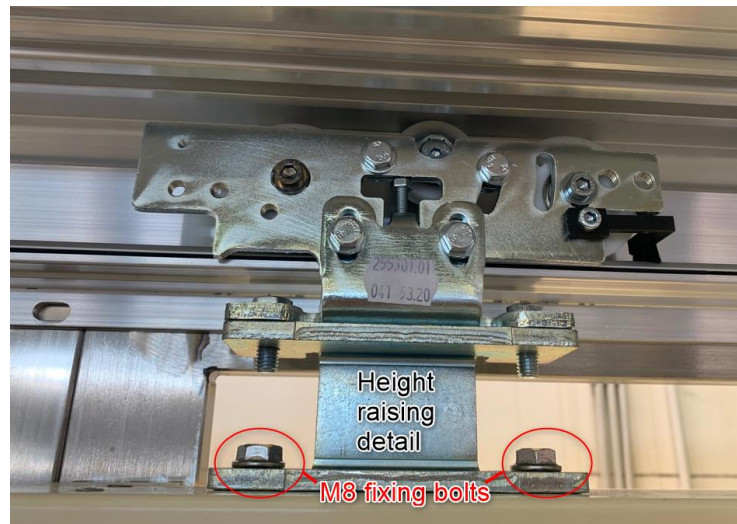

- 3) Check if the distance between door leaf and wall/installation supporting frame is **23mm**. See drawing 5.

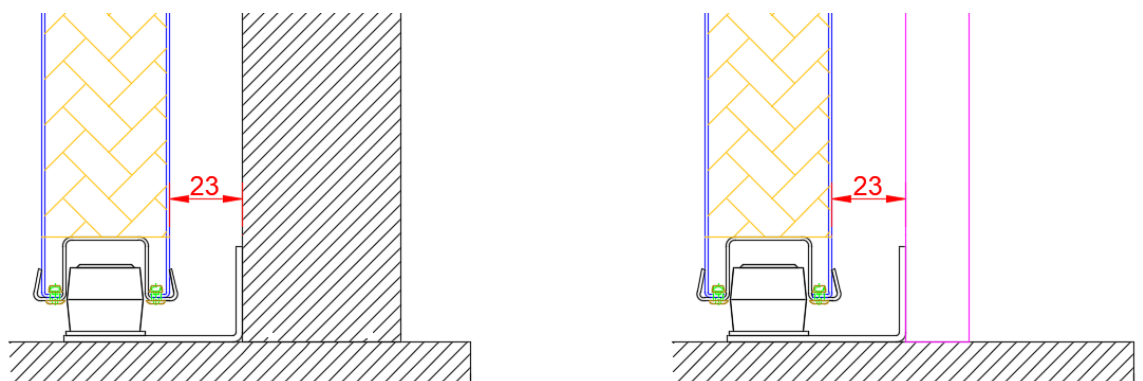

Drawing 5

5. INSTALLATION OF AUTOMATICALLY OPERATED SINGLE SLIDING DOOR FRAME

- 1) Fix the Stop frame to the bulkhead/installation frame with D4x8 pop rivets (drawing 6).



Drawing 6

- 2) Fix the vertical smoke list to the edge of the installation frame or the bulkhead opening edge (drawing 7).

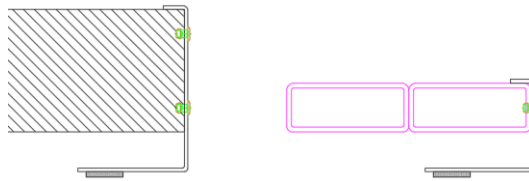

Drawing 7

- 3) Fix the horizontal smoke list to the top edge of the installation frame or the bulkhead top opening edge (drawing 8).

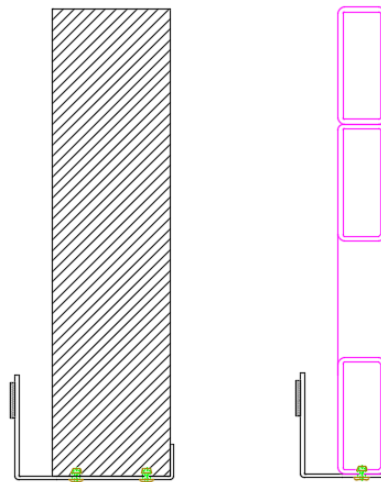

Drawing 8

- 4) Before you tighten the M8 fixing bolts check again the distance between door leaf and bulkhead, it must be **23mm** (drawing 9). Wall frame lists and door leaf smoke lists should not prevent the smooth movement of the door leaf.

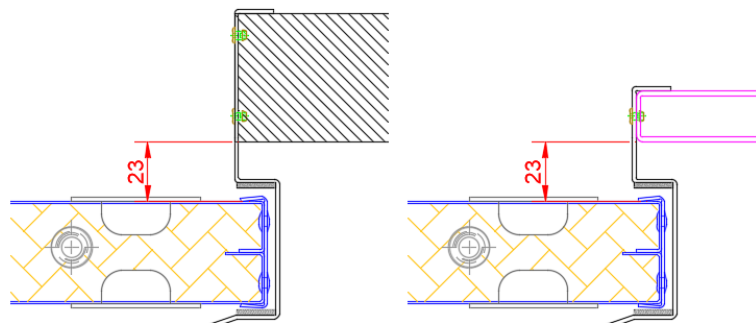

Drawing 9

STEEL PROFILE DOORS / METAL DOORS / MARINE DOORS

6. FINAL SETTINGS

- 1) Fix M8 bolts and adjust the door leaf height (with height adjusting bolts) to get correct distance of 13mm between door leaf and finished floor/sill (drawing 10).

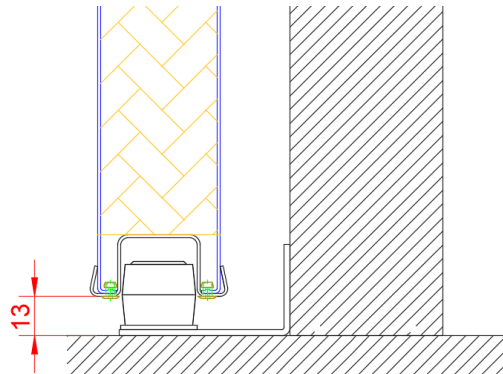

Drawing 10

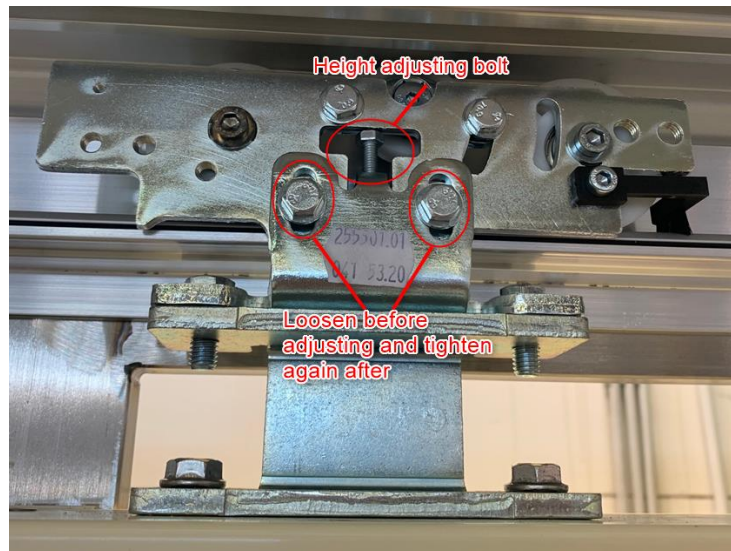

- 2) Check if door is complete, manually running correctly and prepared for commissioning. Settings of the drive system have to be made according to Dorma ES200 instruction.
- 3) For drive system cover use cover fixing details from the drive system set.

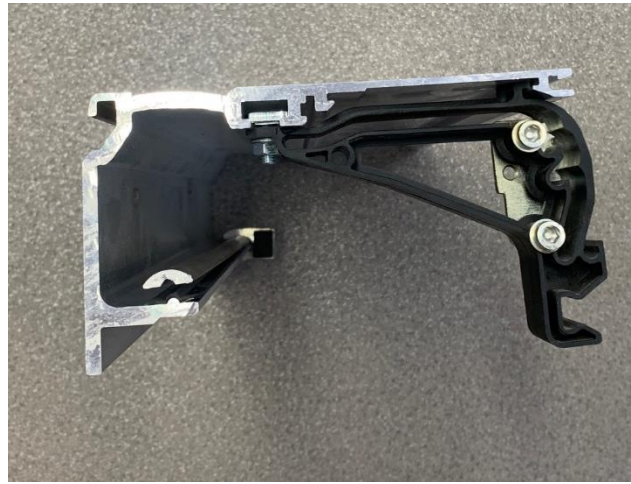

- 4) Fix the drive system cover as shown on the photo.

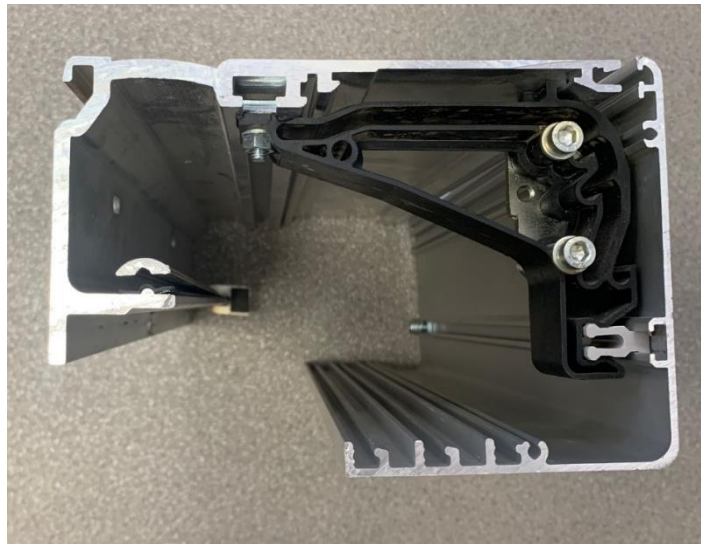

- 5) Place the plastic side covers on both sides of the drive system. Make sure, that the side cover fits in the holes.



STEEL PROFILE DOORS / METAL DOORS / MARINE DOORS

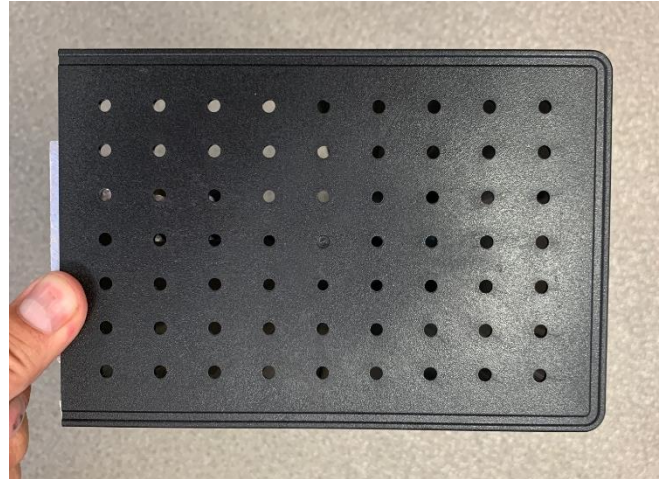
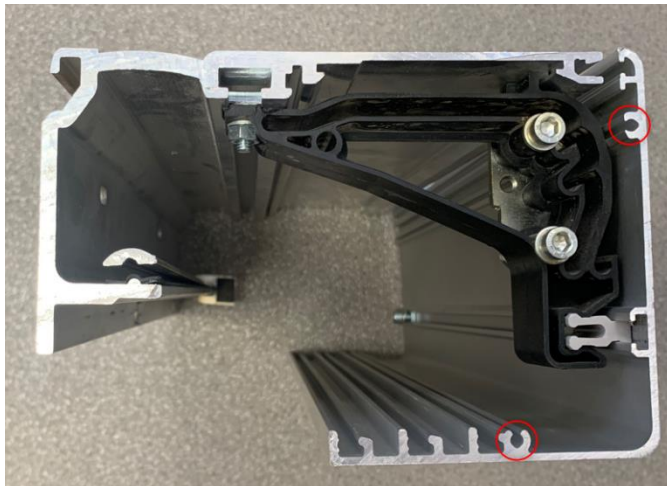

STEEL PROFILE DOORS / METAL DOORS / MARINE DOORS

TAMMER OÜ
Väike-Paala 4
11415 Tallinn, Estonia
Reg. no. 10394201

Phone +372 614 5500
info@tammer.ee
www.tammer.ee

Swedbank AS
EE 372200221007143338
VAT no EE 100364992